



# JotForm Resources



## How to use JotForm Templates

### Option 1: Use URL

1. Click orange “Create New Form” button in upper left corner
2. Import form

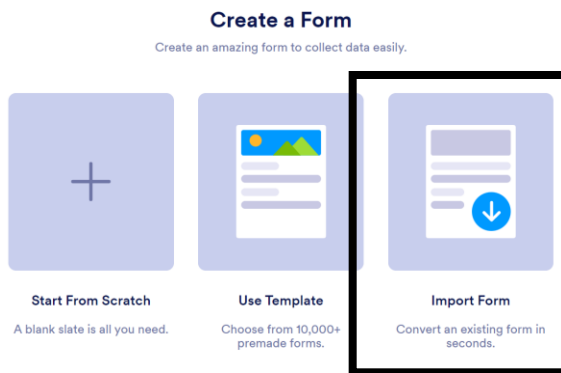

3. Select From a web page

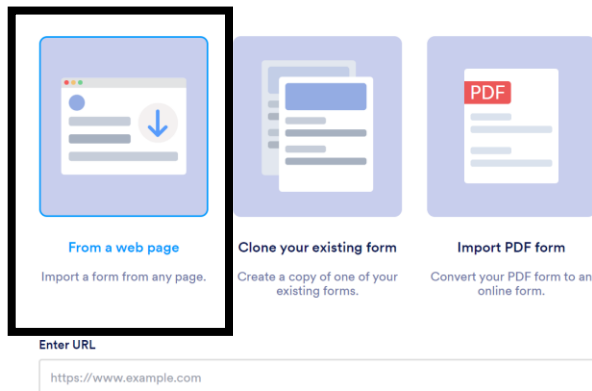

4. Paste URL (from CDEpi survey list) and click blue “create form” button
5. Edit the form to fit the needs for your county

## Option 2: Click the Link

1. Use the link provided by the State or another LHD
2. Click on the link provided and select use template

<https://hipaa.jotform.com/form-templates/covid-19-case-investigation-form> [hipaa.jotform.com]

**COVID-19 Case Investigation Form**

FORM PREVIEW

**HEALTHY GALLATIN**

**COVID-19 Case Investigation Form**  
Gallatin City-County Health Department

Thank you for choosing to complete our contact tracing survey. Due to the high volume of COVID-19 cases, Gallatin City-County Health Department is requesting your assistance in collecting the following information to assist us in our COVID-19 response efforts. **This survey is only for individuals who have tested positive for COVID-19. Please do NOT complete it unless you have had a positive test.**

3. Edit survey to better fit your community. When finished, select publish.

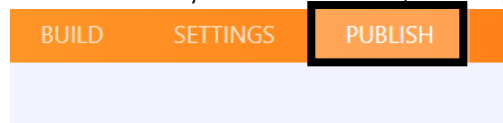

4. Use the link generated from JotForm to send out your new survey.

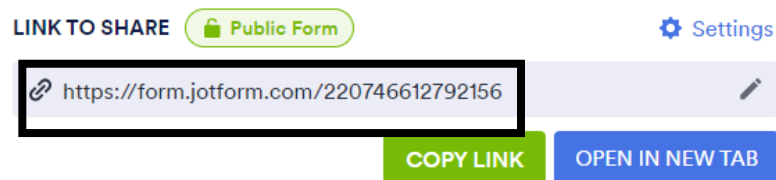

5. Edit the form to fit the needs for your county